

Logging Into Moodle For The First Time

1. Go to **<http://mycourses.tstc.edu>**
3. Login using your WebAdvisor username & password. Use the **last 6 digits of your ID number** if your Password is your TSTC ID number.

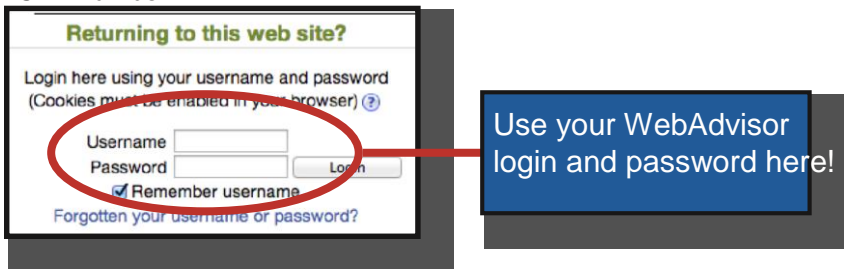

**If you do not know your username, please see "WebAdvisor User Name" handout.*

4. Click your name in the upper right corner of the screen and select "My Profile".
(This can be done from anywhere in Moodle)

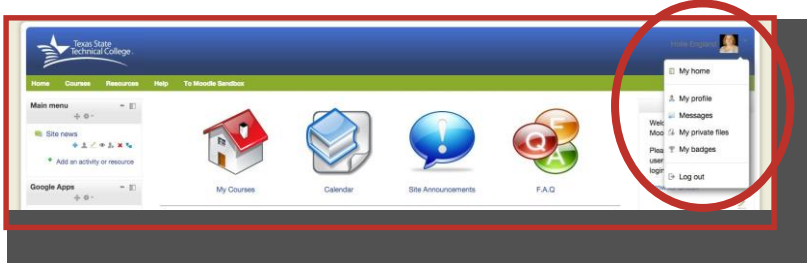

5. Click “Edit Profile” in the Settings Block on the left side of the screen.

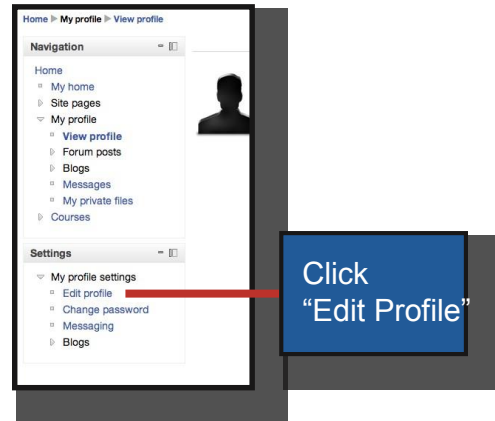

6. Enter a the city, and change the timezone to America/Chicago.

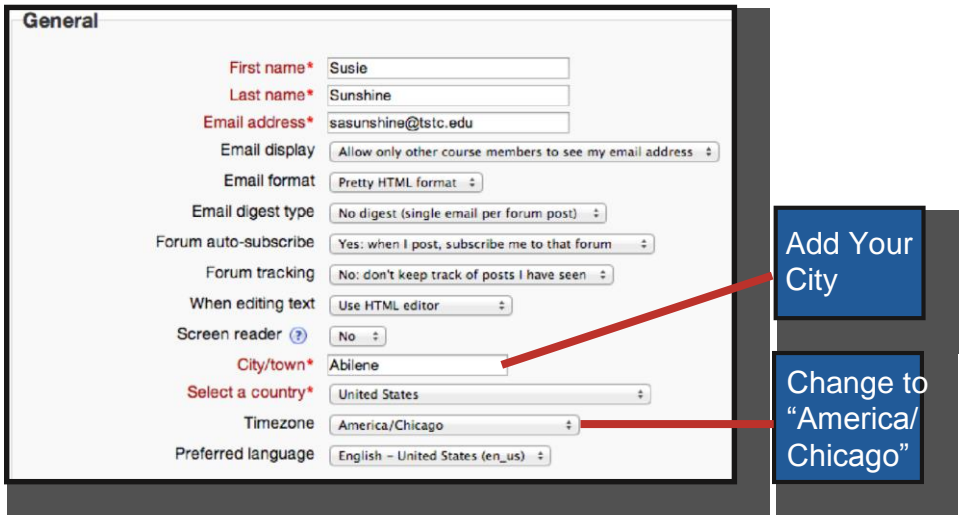

****NOTE:** Your email address is automatically set to your TSTC MyMail email address. This can not be changed in Moodle.

7. There are also several *options* to help enhance your Moodle environment.

- A. You can upload an avatar or profile image
- B. List personal interests
- C. Add other contact information such as a personal webpage, chat ids, ect.

****NOTE:** Phone Numbers & ID Numbers will appear in this “Edit profile” screen, but are private and cannot be viewed publicly.

8. Click “**Update Profile**” at the bottom of the screen.

1. Your current semesters' courses can be accessed by clicking on the **"MyCourses"** icon on the home screen.

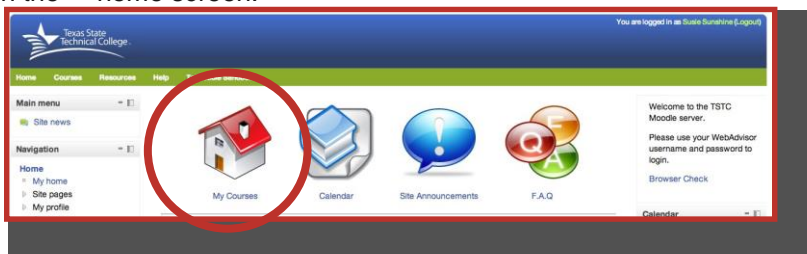

2. This will take you to the MyCourses: My Home Moodle screen. From here you can:

- A. View Latest Announcements
- B. View the Courses Available to You
- C. View a Course Overview of your current courses.

You can also access your current courses from the Navigation Block (Visible from anywhere in Moodle) located on the left side of your screen.

